

# Flex 2 NA 3000, 930 (BBBL), Medium, Black

ITAB

- ✓ Product is title 24 compatible
- ✓ Modern, minimalistic and clean-looking ceiling
- ✓ Available in various lumen packages
- ✓ Available in white, black and grey
- ✓ Tilttable and rotating



## Technical specification

|                           |                       |
|---------------------------|-----------------------|
| Product Code              | 280-72505-20          |
| Colour                    | Black                 |
| Control                   | 0-10 V                |
| CRI light colour          | 930 (BBBL)            |
| Delivered lumen output lm | 2 x 2800              |
| Driver                    | Stand alone, included |
| Light distribution        | Medium                |
| Lightsource               | LED COB               |
| Mains input voltage       | 120-277V              |
| Measurements A            | 20,9                  |
| Measurements B            | 5,2                   |
| Measurements C            | 14,3                  |
| Measurements D            | 11,7                  |
| Measurements E            | 4,3                   |
| Mounting                  | Recessed              |
| Position                  | 360°/60°              |
| Lifetime                  | L80 B10, 50.000h      |
| Protection                | For indoor use only   |
| Sawing instructions unit  | inch                  |
| Sawing instructions x     | 6,97                  |
| Sawing instructions y     | 13,87                 |
| Start Time                | Instant               |
| System power W            | 2 x 24,5              |
| Unit                      | inch                  |

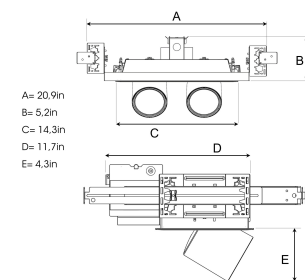

| Spot | 14°  | Medium | 27°  | Flood | 38°  | Wide Flood | 56°  |
|------|------|--------|------|-------|------|------------|------|
| m    | 0.25 | 1.0    | 0.48 | 1.0   | 0.69 | 1.0        | 1.07 |
| ø    | 0.25 | 1.0    | 0.48 | 1.0   | 0.69 | 1.0        | 1.07 |
| 2.0  | 0.49 | 2.0    | 0.95 | 2.0   | 1.39 | 2.0        | 2.14 |
| 3.0  | 0.74 | 3.0    | 1.43 | 3.0   | 2.08 | 3.0        | 3.22 |



6,97 x 13,87in